

DASH NO	CABLES ACCOMMODATED	A DIM	B DIM	C FLATS	D FLATS	E DIA	ASSEMBLE PER
-7	TRC-50-2 TRC-75-2	1.135	.096	.438	.438	.500	TAI-189
-8	8227, BELDEN	1.716	.130	.625	.688	.750	TAI-103
-9	TWC-78-2 TWC-124-2	1.135	.096	.438	.438	.500	TAI-102
-A9	BL782, TIMES BL982, TIMES BL1242, TIMES						
-10	RG-22 754E, AT&T	1.716	.130	.625	.688	.750	TAI-103
-11	760A, AT&T						
-12	16 PEVL, AT&T V1-AL, GENERAL	1.135	.096	.438	.438	.500	TAI-128
-13	TRF-59, TIMES						
-13A	8232, BELDEN	1.716	.130	.625	.688	.750	TAI-129
-14	8233, BELDEN						
-23	250-3884, MICRODOT	1.135	.096	.438	.438	.500	TAI-189
-24	202-3934, MICRODOT						
-24A	9530A5117, RAYCHEM	1.716	.130	.625	.688	.750	TAI-102
-25	T-43M, GENERAL						
-25A	5021HS331, RAYCHEM	1.135	.096	.438	.438	.500	TAI-189
-26	7028A5518, RAYCHEM						
-27	T19TPSJ2619EN, WOVEN 202-3927, MICRODOT 202-3942, MICRODOT	1.716	.130	.625	.688	.750	TAI-102
-29	TWC-78-1/TWC-124-1A						
-30	761A, AT&T 8441, BELDEN	1.135	.096	.438	.438	.500	TAI-189
-32	TRC-50-1						
-33	TRC-75-1	1.716	.130	.625	.688	.750	TAI-102
-42	21-204, ESSEX 4463, CONSOLIDATED						
-43	250-4044/250-4045 293-3930, MICRODOT	1.135	.096	.438	.438	.500	TAI-103
-45	M27500-22TE2T14 1100-66F, STANDARD						
-46	9860, BELDEN	1.716	.130	.625	.688	.750	TAI-189
-47	M17/176-00002						
-49	TWAC-78-1F2	1.135	.096	.438	.438	.500	TAI-102
-54	89207, BELDEN						
-55	89272, BELDEN	1.716	.130	.625	.688	.750	TAI-189
-56	GC875GC1, GRUMMAN						
-57	GC875GB1, GRUMMAN	1.135	.096	.438	.438	.500	TAI-102
-58	GC875TM24H, GRUMMAN						
-59	GC875LN1, GRUMMAN	1.716	.130	.625	.688	.750	TAI-189
-60	M17/177, THERMATICS 380-10045, BOEING						
-64	7528A5314, RAYCHEM						

FIG 1 Δ
-9 SHOWN

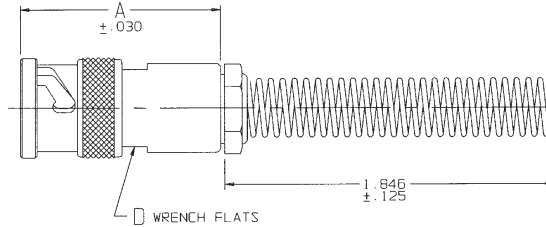
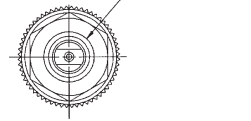
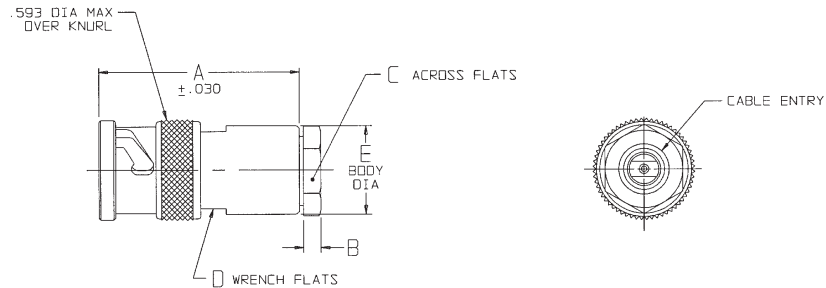

FIG 2
-9 SHOWN



DATA CONTAINED IN THIS DOCUMENT IS PROPRIETARY TO TROMPETER ELECTRONICS INC AND SHALL NOT BE DISCLOSED, COPIED OR USED FOR PROMOTION OR MANUFACTURE WITHOUT EXPRESS WRITTEN PERMISSION OF TROMPETER ELECTRONICS INC.

REVISIONS

REV	DESCRIPTION	DATE	APPROVED
U	REVISED PER ECO 14778	11-5-02	[Signature]

310-0025 SH 1

CABLE ENTRY			
DASH NO	DIA	DASH NO	DIA
-7	.274	-29	.191
-8	.345	-30	.235
-9	.285	-32	.191
-A9		-33	.217
-10	.455	-42	.300
-11	.347	-43	.200
-12	.495	-45	.183
-13	.362	-46	.475
-13A	.352	-47	.164
-14	.490	-49	.132
-23	.183	-54	.323
-24	.191	-55	.250
-24A	.200	-56	.191
-25	.285	-57	
-25A		-58	.198
-26	.191	-59	
-27	.145	-60	.217
		-64	.183

RED INDICATES ORIGINAL

6. EXAMPLE OF A COMPLETE MODEL NO.

PL74 -47 Δ

BASIC MODEL NO. | DASH NO.

Δ IF BEND RELIEF SPRING REQD (SEE FIG 1)
ADD SUFFIX "BR" TO MODEL NO
(NOT AVAILABLE WITH CABLE GROUPS -8,-10,-11,
-12,-13,-13A,-14,-46 & -54)

Δ CLAMP NUT OMITTED
 Δ 2-LUG BAYONET CONCENTRIC TWINAX/TRIAX TRB CABLE PLUG

2. FINISH: TFS-1A (NICKEL)

1. ALL DIM ARE IN INCHES

TYPE Δ	DASH NO/CABLE GROUP																
TWINAX	-8	-9	-A9	-10	-11	-12	-24	-25	-27	-29	-30	-45	-46	-47	-49	-54	-55
TRIAx	-7	-13	-13A	-14	-23	-24A	-25A	-26	-32	-33	-42	-43	-56	-57	-59	-60	-64
QUADRAx	-58																

INTERPRET DIMING PER MIL-STD-100 DIMENSIONS ARE IN INCHES UNLESS FINISH INDICATED UNLESS OTHERWISE SPECIFIED	UNLESS SPECIFIED .XX .XXX ± 005 .XXXX .XXXXX ANGLE(S)	TROMPETER RF connectivity <small>© 2008 connectivity solutions brand</small>
DRAWN: AAH DATE: 11-4-02	MATERIAL:	TITLE: PL74/PL74BR
11-4-02	FINISH:	SIZE: B CAGE CODE: 14949 DRAWING NO: 310-0025 REV: U
11/5/02	SCALE: NONE	DATE: 3/27/08 SHEET: 1C
305-0515 NEXT ASSY	ECO FILE NO: 310-0025U	DO NOT SCALE DIMS