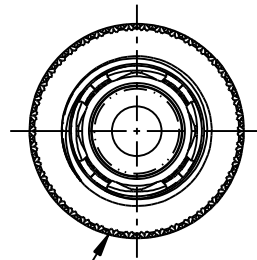
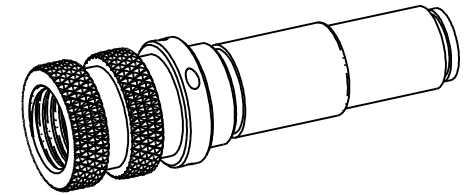
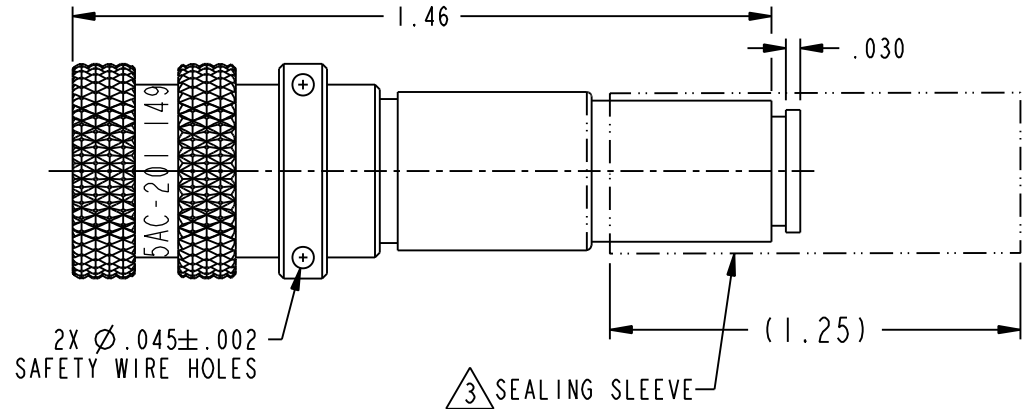

TABLE 1			
ASSEMBLY MODEL NO.	CABLES ACCOMMODATED	ASSEMBLE PER	
PL3455AC-201	M17/176-00002	TAI-162	
PL3455AC-202	TWC-78-1, TROMPETER		
PL3455AC-203	TWC-124-1A, TROMPETER		
PL3455AC-204	10602, RAYCHEM		
PL3455AC-205	TWAC-78-1F2, TROMPETER		
PL3455AC-206	7826D0130, RAYCHEM		
PL3455AC-208	202-3927, MICRODOT		
PL3455AC-209	202-3942, MICRODOT		
PL3455AC-212	2524E0114, RAYCHEM		
PL3455AC-217	GC875TM24H, GRUMMAN		
PL3455AC-218	EPD22188B, RAYCHEM		
PL3455AC-219	2526D1114, RAYCHEM		
PL3455AC-220	GC875RRI, GRUMMAN		
PL3455AC-221	10614, RAYCHEM		
PL3455AC-222	10613, RAYCHEM		
PL3455AC-223	HMS2-1149, HUGHES		
PL3455AC-303	7528A5314, RAYCHEM		TAI-190



2X \varnothing .447 MAX OVER
MALE DIAMOND KNURL



PL3455AC-201 SHOWN

NOTES: UNLESS OTHERWISE SPECIFIED.

1. MATERIAL & FINISH:

- 1.1 BODY, COUPLING SLEEVE & CRIMP BUSHING:
NICKEL PLATED BRASS
- 1.2 INSULATOR: PTFE (TEFLON)
- 1.3 GASKET: SILICONE RUBBER

2. CRIMP BUSHING AND SEALING SLEEVE SHALL
BE SUPPLIED LOOSE.

3. SEALING SLEEVE SHALL NOT BE SUPPLIED
WITH -205, -208 & -223.

4. EXAMPLE OF COMPLETE MODEL NO.:

PL3455AC -201
 └── CABLE GROUP (SEE TABLE 1)
 └── BASIC MODEL NO.

<p>This PROPRIETARY Document is property of Cinch Connectivity Solutions. It is confidential in nature, non-transferable, and issued with the clear understanding that it is not to be traced or copied without permission and is returnable upon demand.</p> <p>INTERPRET DRAWING IN ACCORDANCE WITH ASME Y14.5-2009.</p>	<p>3RD ANGLE PROJECTION</p>	<p>TROMPETER</p>	
	<p>RoHS2 <input checked="" type="checkbox"/></p> <p>2011/65/EU</p>	<p>Title: BODY ASSY, PL3455AC</p>	
	<p>UNLESS OTHERWISE SPECIFIED UNITS: INCH</p> <p>.XX ± .02 .XXX ± .010 ANGLES ± 2°</p>	<p>Model No. PL3455AC-XXX</p>	
	<p>Size A</p>	<p>DO NOT SCALE DRAWING</p>	<p>Date: 9/28/2015</p>