

| DASH NO | CABLES ACCOMMODATED                                       | ASSEMBLE PER |
|---------|---|--------------|
| -23     | 275-3930, MICRODOT  | TAI-127      |
| -24     | 202-3934, MICRODOT  | TAI-125      |
| -24A    | 9530A5117, RAYCHEM  | TAI-127      |
| -27     | 202-3927, MICRODOT <sup>5</sup><br>73-1317911-1, SYLVANIA | TAI-125      |
| -29     | TWC-124-1A<br>TWC-78-1                                    | TAI-125      |
| -30     | B441, BELDEN <sup>4</sup><br>761A, W.E.CO.                |              |
| -32     | TRC-50-1  | TAI-127      |
| -33     | TRC-75-1  |              |
| -43     | 250-4044/250-4045<br>293-3930 MICRODOT                    | TAI-174      |
| -45     | 10602, RAYCHEM  | TAI-125      |
| -47     | MIL/176-00002 <sup>5</sup>                                |              |
| -49     | TWAC-78-1F2 <sup>5</sup>                                  |              |
| -56     | GC875GC1, GRUMMAN   | TAI-174      |
| -57     | GC875GB1, GRUMMAN   |              |
| -58     | GC875TM24H, GRUMMAN                                       | TAI-125      |
| -9      | TWC-124-2 <sup>4</sup>                                    |              |
| -55     | TWCP-124-3 <sup>4</sup>                                   |              |

DATA CONTAINED IN THIS DOCUMENT IS PROPRIETARY TO TROMPETER ELECTRONICS, INC. AND SHALL NOT BE DISCLOSED, COPIED OR USED FOR PROCUREMENT OR MANUFACTURE WITHOUT EXPRESS WRITTEN PERMISSION OF TROMPETER ELECTRONICS, INC.

| REVISIONS |                       | 315-0027 | SH 1      |
|-----------|-----------------------|----------|-----------|
| REV       | DESCRIPTION           | DATE     | APPROVED  |
| N         | REVISED PER ECO 14786 | 11-5-02  | <i>AM</i> |

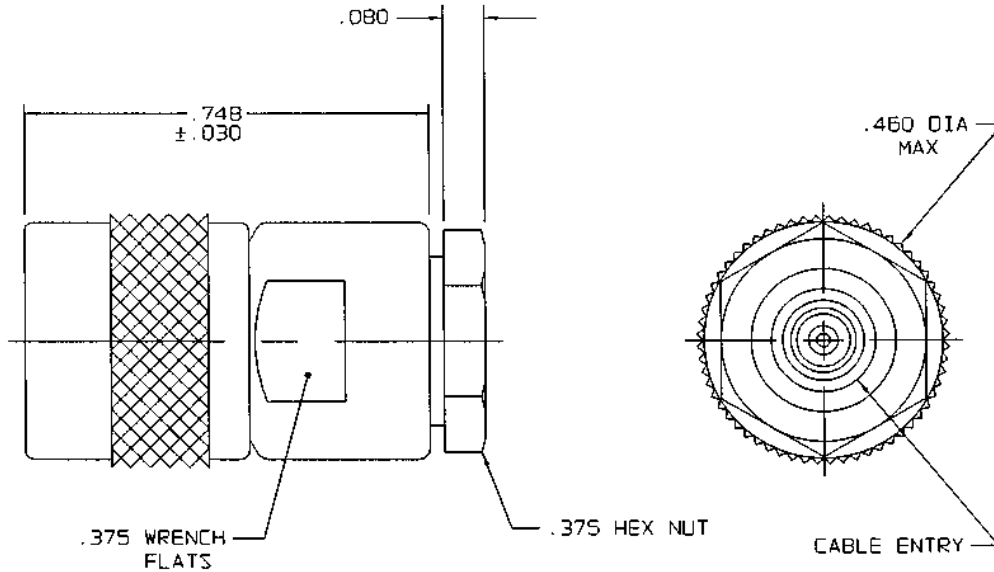

-29 SHOWN

<sup>5</sup> .187 LG JACKET SLITS MAY BE REQUIRED FOR EASE OF ASSY

<sup>4</sup> NOT WRENCH CRIMP

3. CONCENTRIC TWINAX/TRIAX SUBMINIATURE 4-LUG TRS PLUG
2. FINISH: NICKEL
1. ALL DIM ARE IN INCHES

|   |                 |  |                        |                       |                         |
|---|-----------------|--|------------------------|-----------------------|-------------------------|
| INTERPRET DRAWING PER<br>MIL-STD-100<br>DIMENSIONS ARE IN INCHES<br>AND UNLESS FINISH THICKNESS<br>UNLESS OTHERWISE SPECIFIED |                 | TOL: UNLESS SPECIFIED<br>.XX<br>.XXX ± .005<br>.XXXX<br>ANGLES |                        |                       |                         |
| DRAWN<br>AAH  | DATE<br>11-4-02 | MATERIAL:  | TITLE:<br>PL155FL      |                       |                         |
| CHECKED<br><i>JLM</i>   | DATE<br>11-4-02 | FINISH:  | SIZE<br><b>A 14949</b> | CAGE CODE<br>315-0027 | DRAWING NO.<br>315-0027 |
| QUALITY<br><i>[Signature]</i>   | DATE<br>11-5-02 | DO NOT SCALE DWG   | DATE: 10/9/2024        | SHEET<br>1            | REV.<br>N               |
| NAME<br><i>[Signature]</i>  | DATE<br>11/5/02 |  |                        |                       |                         |
| APPROVED<br><i>[Signature]</i>  | DATE<br>11/1/02 |  |                        |                       |                         |