

DRAWING REVISIONS  
(RELEASE DATE ON FILE)

REV	DOCUMENT	APP	APPROVAL DATE
A	CCS11405	JW	2/28/23

FEATURES:

- 96 Circuits
- Housing: PBT+30% Glass Filled UL 94V-0
- Contact: Phosphor Bronze, Gold, Tin Tails
- Board Lock: Brass, Tin

SPECIFICATIONS:

- Current rating: 2A
- Temperature range: -55° C to + 125° C
- Contact resistance: 20mΩ max.
- Mating Force: .93N max. per pin

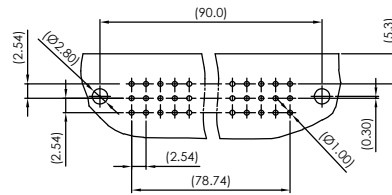
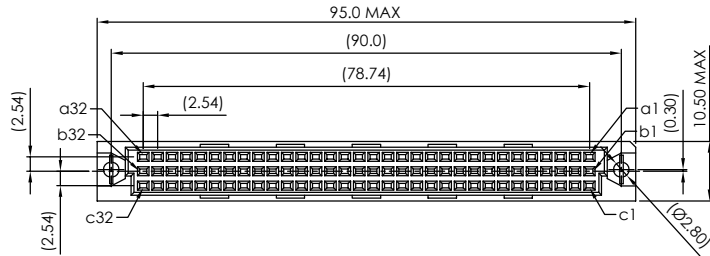

Recommended P.C Board Hole Layout

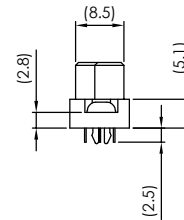
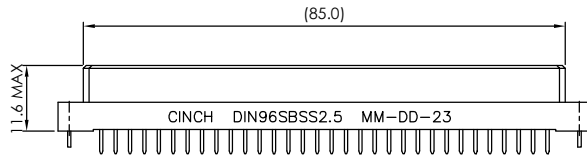

UNITS METRIC	AUTOCAD SCALE 2/23/23	<b>CINCH</b> 1000 FINLEY RD LOMBARD, IL 60148
DO NOT SCALE DRAWING UNLESS OTHERWISE SPECIFIED: DIMENSIONS ARE IN MILLIMETERS	<b>DESIGN ENGINEER</b> J. WARRACH	TITLE DIN 41612 SERIES FEMALE SOLDER TYPE
FILED RAZI TOLERANCES AND FINISHES: DIMES: ANGULAR ADJUSTIVE FINISH	<b>APPROVALS</b> ON FILE	MATERIAL SPECIFICATIONS MATERIAL: N/A FINISH: N/A CHECKED SPECIFICATIONS SEE NOTES N/A
<b>CONFIDENTIAL</b> THIS DOCUMENT IS THE PROPERTY OF CINCH CORPORATION. IT IS TO BE KEPT CONFIDENTIAL AND NOT TO BE REPRODUCED OR TRANSMITTED IN ANY FORM OR BY ANY MEANS, ELECTRONIC OR MECHANICAL, INCLUDING PHOTOCOPYING, RECORDING, OR BY ANY INFORMATION SYSTEMS.	DRAWING NUMBER: 25053-96F2013-CINCH-PB	SCALE: 1:1 SHEET 1 OF 1
71785	B	