

4-40 UNC-2B TAP 4,000
 #43 DRILL (2,261) 4,471

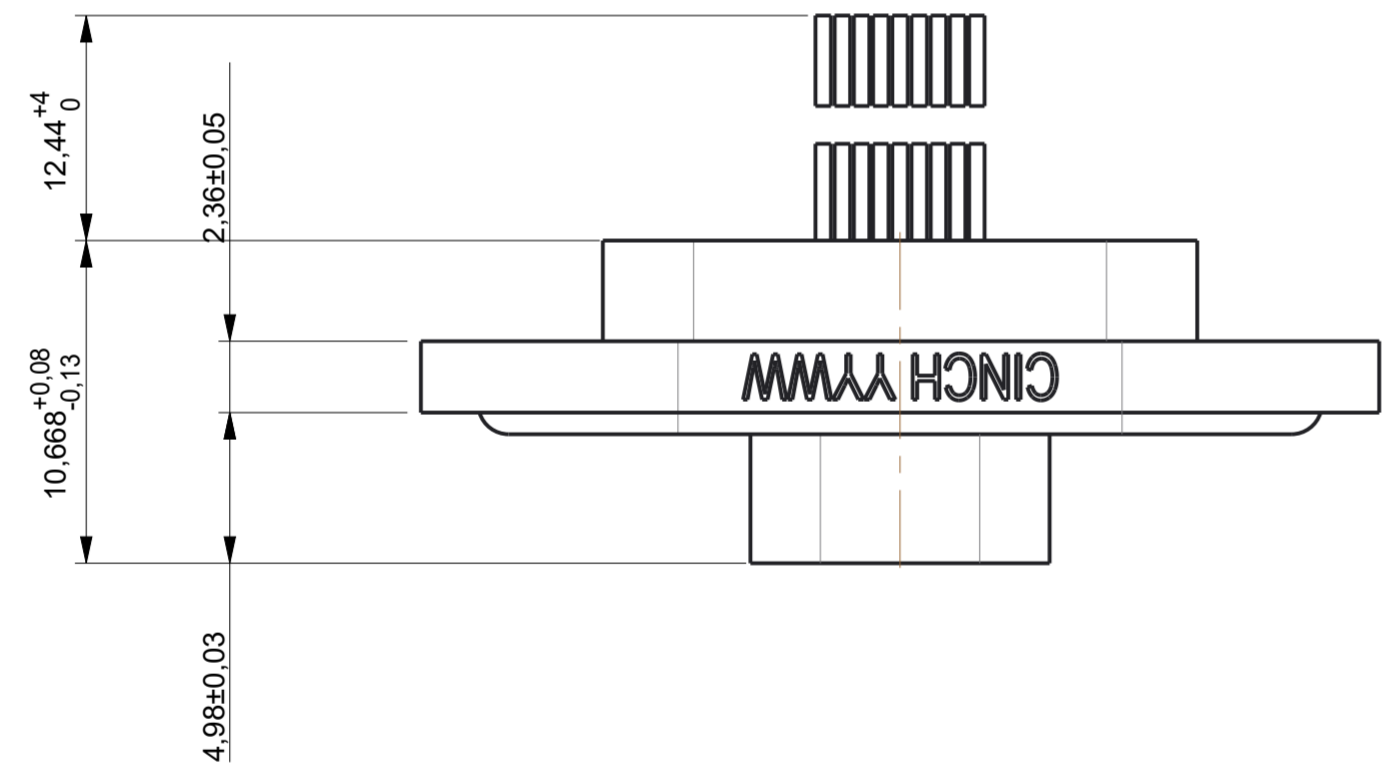

| PART NUMBER | A | B | C | H | DESCRIPTION2 |
|-------------|-------|------|-------|------|--------------------------|
| DN0000809 | 10,11 | 6,32 | 14,35 | 3,30 | 9W REVERSE MOUNT PANEL |
| DN0000815 | 13,92 | 6,32 | 18,16 | 3,30 | 15W REVERSE MOUNT PANEL |
| DN0000821 | 17,73 | 6,32 | 21,97 | 3,30 | 21W REVERSE MOUNT PANEL |
| DN0000825 | 20,27 | 6,32 | 24,51 | 3,30 | 25W REVERSE MOUNT PANEL |
| DN0000831 | 24,08 | 6,32 | 28,34 | 3,30 | 31W REVERSE MOUNT PANEL |
| DN0000837 | 27,89 | 6,32 | 32,13 | 3,30 | 37W REVERSE MOUNT PANEL |
| DN0000851 | 26,62 | 7,42 | 30,86 | 3,30 | 51W REVERSE MOUNT PANEL |
| DN0000810 | 39,00 | 8,52 | 45,72 | 4,10 | 100W REVERSE MOUNT PANEL |

| PART NUMBER | SALES_CODE | L_MAX | M_MAX | R_BASIC | W_MAX | Y_MAX | DESCRIPTION2 |
|-----------------|------------------|-------|-------|---------|-------|-------|-------------------------|
| DN00012000096FN | DCDH-9S4C40.5BN | 31,78 | 8,64 | 14,35 | 17,10 | 4,88 | 9W PCB SOCKET ASSEMBLY |
| DN00012000156FN | DCDH-15S4C40.5BN | 34,26 | 12,45 | 18,16 | 17,10 | 4,88 | 15W PCB SOCKET ASSEMBLY |
| DN00012000216FN | DCDH-21S4C40.5BN | 39,25 | 16,26 | 21,97 | 17,10 | 4,88 | 21W PCB SOCKET ASSEMBLY |
| DN00012000256FN | DCDH-25S4C40.5BN | 41,76 | 18,80 | 24,51 | 17,10 | 4,88 | 25W PCB SOCKET ASSEMBLY |
| DN00012000316FN | DCDH-31S4C40.5BN | 44,23 | 22,61 | 28,32 | 17,10 | 4,88 | 31W PCB SOCKET ASSEMBLY |
| DN00012000376FN | DCDH-37S4C40.5BN | 49,22 | 26,42 | 32,13 | 17,10 | 4,88 | 37W PCB SOCKET ASSEMBLY |
| DN00012000516FN | DCDH-51S4C40.5BN | 48,60 | 25,15 | 30,86 | 18,20 | 5,99 | 51W PCB SOCKET ASSEMBLY |

NOTES:

- DIMENSIONS ARE FOR REFERENCE ONLY.
- CUSTOMER DRAWING ONLY. NOT USED FOR CINCH MANUFACTURE.
- PART MARK CONNECTORS WITH CINCH AND DATE-CODE.
- CONNECTOR TO BE HERMETICALLY TESTED TO 1×10^{-8} cc/sec @ 1 ATMOSPHERE HELIUM.

MATERIAL SPECIFICATIONS:

- CONNECTOR SHELL: >ASTM ALLOY< SAE-AMS-QQ-A-250. ELECTROLESS Ni PER SAE-AMS-C-26074.
- CONTACT (FEMALE SOCKET): >Cu ALLOY<. Au PER MIL-DTL-45204, TYPE 1.
- INSULATOR: >PBT< PER MIL-M-24519.
- INTERFACIAL GASKET: >FVMQ< PER MIL-R-25988 OR >PMQ< PER ZZ-R-765.
- HARDWARE: >303SS< PASSIVATE DIP PER SAE-AMS-QQ-P-35. HARDWARE TO BE PURCHASED SEPERATELY TO SUIT PANEL THICKNESS.
- DUSTCAP: >LDPE< OR ANTI-STATIC >HDPE<.

GENERAL SPECIFICATIONS:

- ALL OTHER DETAILS AND DIMENSIONS TO BE AS PER MIL-DTL-83513 OR CINCH HERMETIC DURA-CON CATALOGUE.

THIS DRAWING IS COPYRIGHT AND IS ISSUED ON CONDITION IT IS NOT COPIED, REPRODUCED OR DISCLOSED TO A THIRD PARTY WITHOUT THE CONSENT IN WRITING OF Cinch CONNECTIVITY SOLUTIONS LTD. ATTENTION IS DRAWN TO THE FACT THE ARTICLE DISCLOSED MAY BE COVERED BY BRITISH OR FOREIGN PATENTS. GRANTED OR PENDING OR REGISTERED DESIGN.

| TITLE | | GEN. TOLERANCES | | DATE | | APPD | | ISSUE | |
|--|----------------------------|------------------|-------------------|----------------|-----------|----------------|-----------|-------|----|
| HERMEYC MICROMINIATURE 9-51W SOCKET ASSEMBLY PCB TAILS | | 2 DEC. PL ±0.1 | 1 DEC. PL ±0.2 | 02-Feb-17 | 04-May-22 | PRELIM. | D17647 | ECN | 1 |
| MATERIAL SPECIFICATION | | 0 DEC. PL ±0.5 | ANGULAR ±1 | DATE 02-Feb-17 | SCALE 4:1 | DATE 02-Feb-17 | SCALE 4:1 | CHD | MB |
| FINISH TREATMENT | | TOOL R MAX. 0.18 | FINISHED HARDNESS | RAW MATL | | | | APPD | KG |
| COLOUR | | | | | | | | | |
| CODE | DESCRIPTION | ITEM | FINISH/MATL | QTY | | | | | |
| | HERMETIC COMPOUND | 8 | | | | | | | |
| | 24AWG SOLID WIRE | 7 | | | | | | | |
| | O-RING SEAL (9W) | 6 | | | | | | | |
| | 9W SEALING GASKET | 5 | | | | | | | |
| | 9W SKT INSULATOR | 4 | | | | | | | |
| | 9W SKT DUSTCAP | 3 | | | | | | | |
| | SKT CONTACT CRIMP 24 GAUGE | 2 | | | | | | | |
| | 9W OUTER SKT SHELL PLTD | 1 | | | | | | | |